



# Hook Fast Purlin Bridging

Millform *HookFast*® Bridging System

(available to suit C/Z100, 150, 200 & 250)



**AdJ Starter – Adjustable Female / Fascia Cleat**

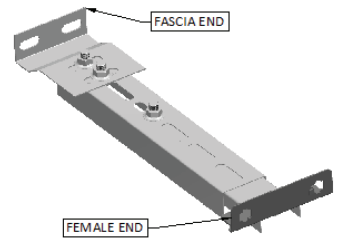

**Starter – Bolted / Female**

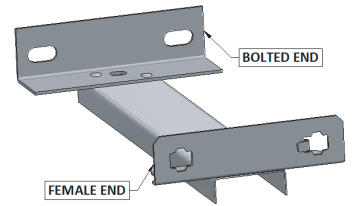

**Intermediate – Male / Female**

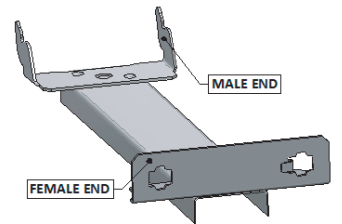

**Finisher – Male / Bolted**

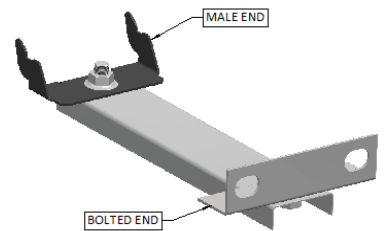

**12 mm Sag Rod Ridge Tie (add 100 mm to centres)**

